



WOODBURY RIDGE

LOT 43

SUTTON NSW

HILLTOP LOT

LOT DISCLOSURE PLAN

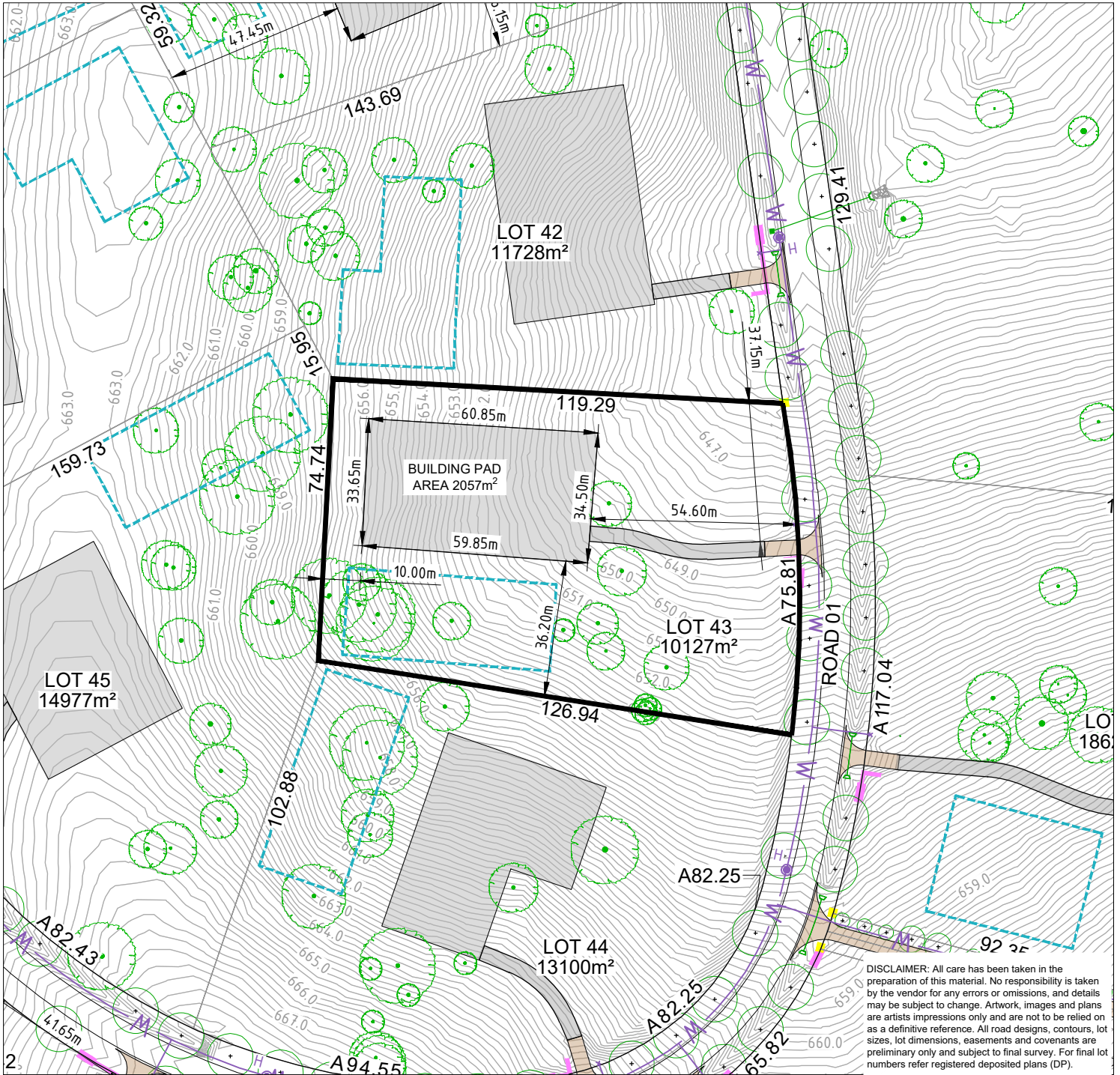

DISCLAIMER: All care has been taken in the preparation of this material. No responsibility is taken by the vendor for any errors or omissions, and details may be subject to change. Artwork, images and plans are artists impressions only and are not to be relied on as a definitive reference. All road designs, contours, lot sizes, lot dimensions, easements and covenants are preliminary only and subject to final survey. For final lot numbers refer registered deposited plans (DP).

LOT LAYOUT - SCALE 1:1500 (A4)

REVISION E

DATE 11-07-2023

LEGEND

LOT BOUNDARY		EASEMENT (Telstra, Stormwater & Electrical)		EXISTING TREE	
BUILDING ENVELOPE		BORE RETICULATED WATER MAIN & TIE		PROPOSED STREET TREE	
FINISHED SURFACE CONTOURS - MAJOR (1.0m)		STREETLIGHT		INDICATIVE EFFLUENT MANAGEMENT ZONE	
FINISHED SURFACE CONTOURS - MINOR (0.2m)		SUBSTATION		PEDESTRIAN PATH - 1.5m	
BLOCK AREA / BOUNDARY LENGTH (m)	5000m ² 4.54	ELECTRICAL PILLAR / PIT		PLANTING BY DEVELOPER	
STORMWATER (Pit, Culvert, Headwall + Rock Treatment)		NBN PIT AND TIE FOR FUTURE NBN CONNECTION DRIVEWAY BY DEVELOPER (TWO COAT SEAL)		REFER TO FENCING BY DEVELOPER PLAN AND PROPERTY ENTRANCE PLAN FOR BLOCK FENCING AND GATE DETAILS.	
STORMWATER DRIVEWAY CULVERT		DRIVEWAY BY PURCHASER			

LOCALITY PLAN

